

Campus Plan



- A** – Cracow University of Economics (Campus)
- B** – Cracow Railway Station (Main Station)
- C** – Chopin Hotel
- D** – Europejski Hotel
- E** – Rynek Underground
- F** – Sukiennice
- G** – Wierzynek
- H** – Wielopolskich Palace

- Enter 1** – from City Center Side (Railway Station, Main Square, Europejski Hotel)
- Enter 2** (nearby 'Ustronie') – from Rondo Mogilskie Stop side, Chopin Hotel (from hotel it's about 5 min on foot)

Airport plan

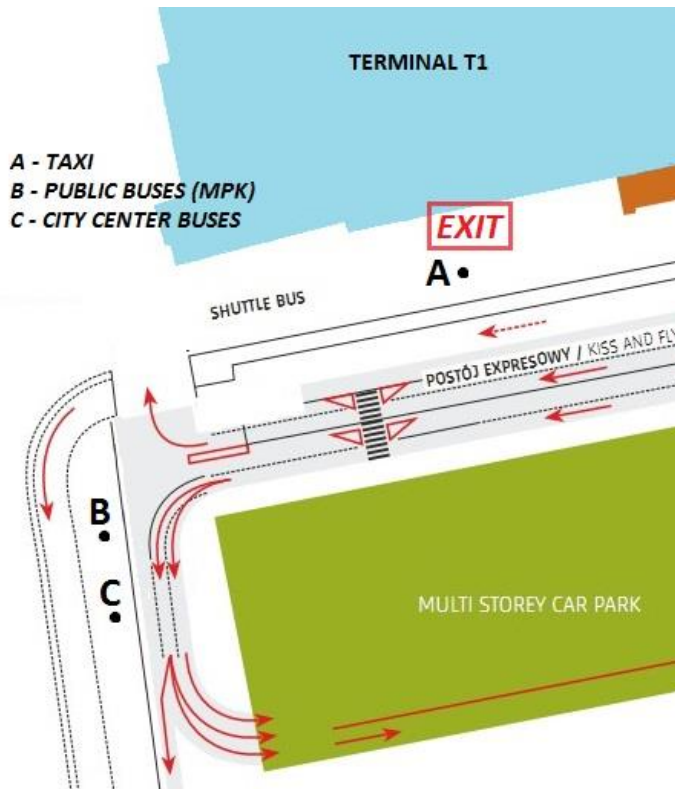

If you are going to get a public bus (MPK) from Airport, you should buy ticket Zone I+II Agglomeration (any one journey for 1 person costs 3.80 PLN).

You can get from the Airport to the Main Train Station: MPK lines 208, 292, 902 (night bus)

TAXI

Taxi from Balice airport to the city centre: about 70 PLN (+48 12 258 0 258)

See more at: <http://www.krktaxi.pl/>

The general rule in most taxi: approx. 7 PLN fee plus 2 PLN charge for each kilometer. In the majority of the taxi you can pay by card, but before entering, make sure.

Taxi numbers:

Megataxi: 12 196 25, 124 000 000

Taxi Grosik: 12 196 69

Taxi Barbakan: 12 196 61

Taxi Wawel: 12 196 66

Taxi Dwójki: 12 196 22, 124 222 222

1€ = about 4.20 PLN (zł)

Timetable for 292 bus, weekdays (from Balice Airport)

AM 4:50; 5:30; 5:50; between 6AM and 10PM (each hour) X:10; X:30; X:50;
PM 11:05

Timetable for 292 bus, Saturday and Sunday (from Balice Airport)

AM 4:50; 5:35; 6:05; 6:30; 6:50
between 7AM and 9PM (each hour) X:10; X:30; X:50
PM 10:10; 10:35; 11:05

Timetable for 208 bus, weekdays (from Balice Airport)

AM 4:35; 5:20; 6:20; 7:20; 8:20; 9:20; 11:20;
between 1PM and 9PM (each hour) X:20

Timetable for 208 bus, Saturday and Sunday (from Balice Airport)

between 5AM and 9AM (each hour) X:20
AM 11:20
between 1PM and 9PM (each hour) X:20

Timetable for 902 bus, all days (from Balice Airport)

PM 11:25
AM 0:21; 1:21; 2:21; 3:21; 3:55

KRAKÓW CITY CENTER BUS

Transport by comfortable tourist buses.

Stop at the airport: CITY CENTER BUS – Balice airport – marked, located next to the stop of the MPK, about 100-150 meters from the airport exit.

Stop in Krakow CITY CENTER BUS – Central Station.

Tickets can be purchased directly on the bus.

TICKET PRICES:

20 PLN – one way, 30 PLN – in two directions, children up to 4 years – free of charge

Departure from the Airport to Cracow:

Monday-Thursday: AM 9.15, 11.15, PM 1.15, 4.15, 7.00

Friday and Sunday: AM 10.00, 11.15, 12.15, PM 1.15, 2.45, 4.45 6.45

Saturday: AM 10.45, PM 2.45, 5.00

Public Transport (MPK) in the city

Ticket prices (PLN)	Normal	Half-rate
Any one journey for 1 person	3.80	1.90
Any two journeys for 1 person twice validate tickets	7.20	3.60
Short-term for 1 person		
20-minute	2.80	1.40
40-minute	3.80	1.90
60-minute	5.00	2.50
90-minute	6.00	3.00
24-hour	15.00	7.50
48-hour	24.00	12.00
72-hour	36.00	18.00
7-days	48.00	24.00

Any one journey group ticket (up to 20 people)	36.00	18.00
------------------------------------------------	-------	-------

Ticket machines by bus stops accept coins, bills or card. Ticket machines in vehicles accept coins only. Transfers free of charge: children under 4 years, people over 70 years
Half-rate tickets: students of foreign schools under 26 years

You can find bus and tram connections, departures, schedules at <http://krakow.jakdojade.pl> from your computer or at <http://m.jakdojade.pl> from your smartphone. Timetables for public transport are also available on the website: <http://rozklady.mpk.krakow.pl>

From the **Chopin Hotel** to the **Wielopolskich Palace** you can get by tram 10 ('Rondo Mogilskie' stop) to the 'Św. Gertrudy' stop and next on foot along Dominikańska street about 5 min to the Wielopolskich Palace (about 15 minutes). The second way is by tram 50 ('Rondo Mogilskie' stop) to the 'Starowiślna' stop and next by tram 1 from the 'Starowiślna' stop to the 'Plac Wszystkich Świętych' stop (about 25 minutes).

From the **Chopin Hotel** to the **Campus** you can get on foot (about 5 min).

From the **Europejski Hotel** to the **Wielopolskich Palace** you can get by tram 10 from 'Dworzec Główny' stop to the 'Św. Gertrudy' stop and next on foot along Dominikańska street about 5 min to the Wielopolskich Palace (about 10 minutes). Or by tram 2, 4, 14, 20 or 24 from 'Dworzec Główny' stop to the 'Teatr Bagatela' stop and next by tram 8 or 13 from the 'Teatr Bagatela' stop to the 'Plac Wszystkich Świętych' stop (about 15 min).

From the **Europejski Hotel** to the **Campus** you can get by tram 2 from 'Dworzec Główny' stop to the 'Rakowicka' stop (about 7 min).

From '**Fafik**' to the **Wielopolskich Palace** you can get by tram 8 or 13 from the 'Urzędnicza' stop to the 'Plac Wszystkich Świętych' stop (about 15 min).

From '**Fafik**' to the **Campus** you can get by tram 4, 14 or 24 from the 'Urzędnicza' stop to the 'Rondo Mogilskie' stop (about 25 min).

TAXI FOR SMARTPHONE'S USERS

If you're a Smartphone's user, you can install the application, thanks to which you will be able to order a taxi, even without knowing the address your position. You are located through GPS. Even without knowing the exact address you can order your taxi. The application allows you to easily order a MEGA TAXI in Krakow using a GPS, but also by typing an address or by connecting to its controller. You can find it at this address:

<https://play.google.com/store/apps/details?id=pl.esyscoder.esystaxi.client.megataxikrakow&hl=pl>